



Tel: 01159 523 302 Mobile: 07900 258 070

Building & Design Services (Nottm) Ltd



Once your project has received planning permission, you will be allowed up to 3 years to start your project. With most projects technical drawings will be required; to comply with the Building Regulations and to provide further technical details to your appointed builder.

Stage Two – Building Control – Technical Drawings Most builders require these drawings to provide a firm quote.

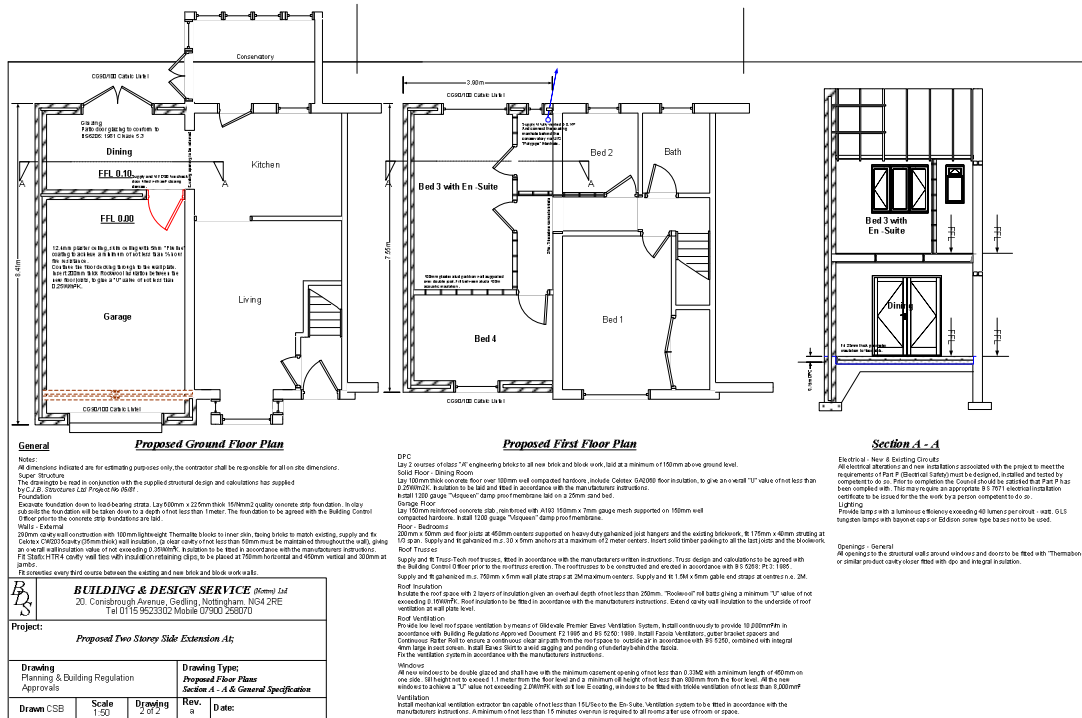

BUILDING & DESIGN SERVICE (Nottm) Ltd 20 Conisbrough Avenue, Gedling, Nottingham, NG4 2RE Tel: 0115 9523332 Mobile: 07900 258070	
Project: Proposed Two Storey Side Extension 1/1	
Drawing: Planning & Building Regulation	Drawing Type: Proposed Floor Plans
Approvals:	Section A - A & General Specification
Drawn: CSB	Scale: 1/50
Drawn: 2 of 2	Rev: a
Date:	

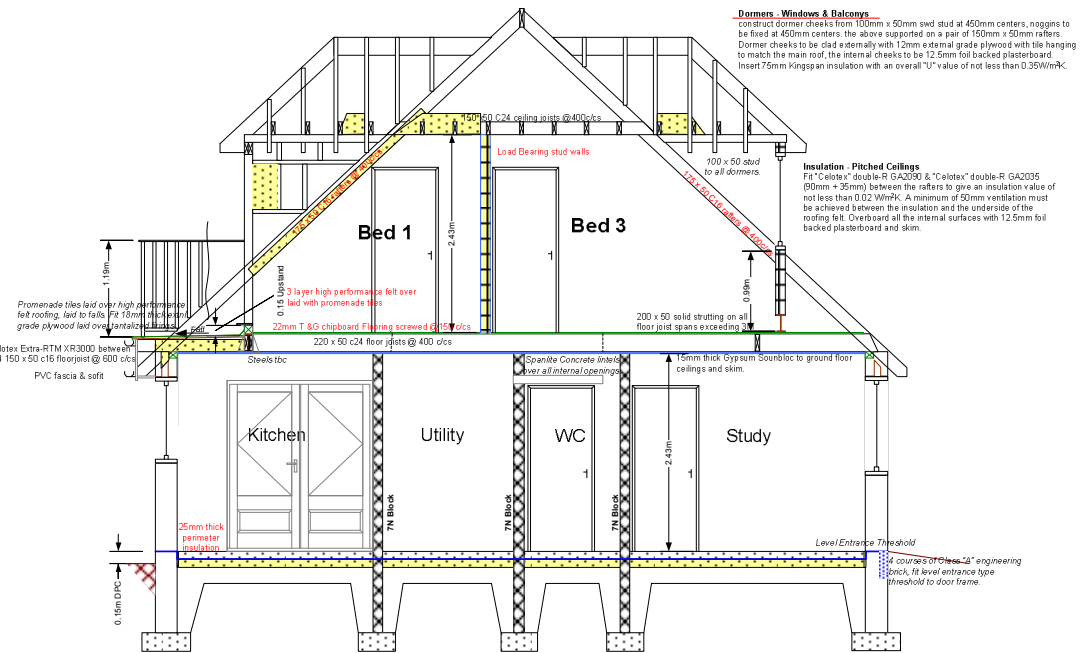

Section A - A